

KNIFE FLAKERS

SRC

SRC is an advanced flaking machine offering the lowest energy consumption and highest capacity on the market, processing up to 18t/h BD.

TECHNICAL FEATURES

- Knife ring flaker designed for high-quality particleboard production
- Patented wobble spreader disc for optimal chip distribution inside the machine
- Independently driven eccentric disc to enhance precision and efficiency
- Optimized chip distribution for maximum knife cutting edge utilization, reducing energy consumption and wear costs
- Extensive research to determine the ideal cutting edge and knife configuration (e.g., 54 knives)
- Automated oil lubrication system for main bearings to minimize maintenance
- High-precision rotor with counterknife presetting system
- Feeding door with air cleaner to remove heavy pollutants

BENEFITS

- Homogeneous flake granularity and precise wood cutting to enhance particleboard's physical and mechanical properties
- Optimized edge cutting reduces glue consumption
- Very low specific energy consumption for cost-effective operation
- Consistent wear part consumption, ensuring predictable maintenance costs

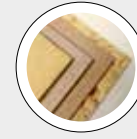
BEST IN CLASS FOR:

WOOD BASED PANELS:
PB/SPB
OSB/LSB/FOSB

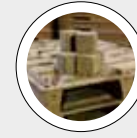

PRESSED WOOD PACKAGING:
PALLET BLOCKS
PRESSED PALLETS



PELLETS & ENERGY:
WOOD PELLETS AND
BLACK PELLETS

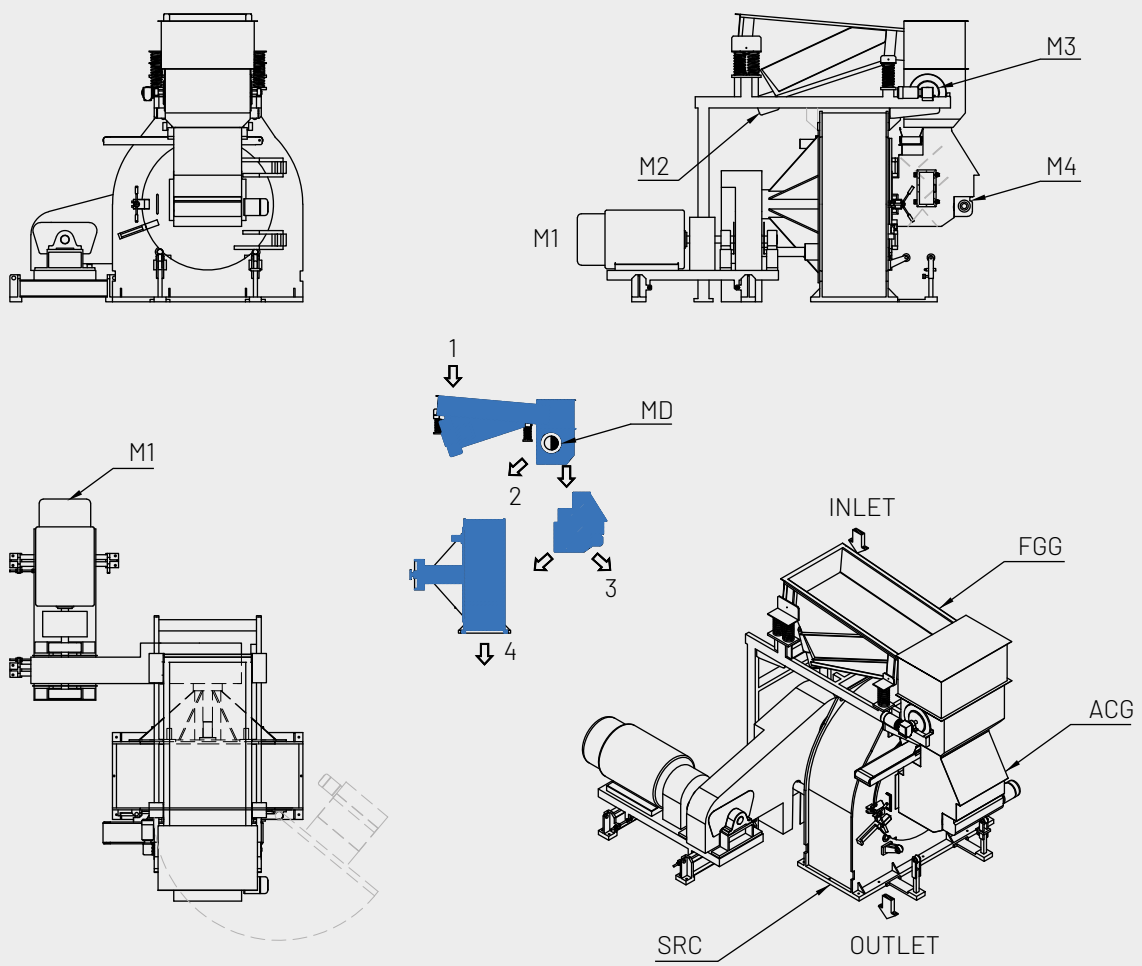

- 1 = INFEED CHIPS
- 2 = FERROUS POLLUTANTS
- 3 = HEAVY POLLUTANTS
- 4 = FLAKES
- M1 = MAIN MOTOR
- M2 = VIBRATING FEEDER
- M3 = MAGNETIC DRUM (MD)
- M4 = WIND SELECTOR



MODEL	OVERALL DIMENSIONS mm	KNIFE RING DIAMETER mm	KNIVES No.	DIMENSION OF KNIVES mm	MAIN MOTOR kW	WEIGHT WITHOUT MAIN MOTOR kg
SRC 14.490	2500 x 2850 x 2350	1400	54	490 x 90 x 4	250	8500
SRC 14.690	2500 x 3200 x 2350	1400	54	690 x 90 x 4	315	10000

SRC 14.690

