

KNIFE FLAKERS

RCG**BEST IN CLASS FOR:**

WOOD BASED PANELS:
PB/SPB
OSB/LSB/FOSB

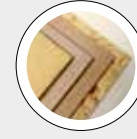
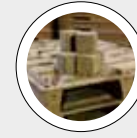

PRESSED WOOD PACKAGING:
PALLET BLOCKS
PRESSED PALLETS



PELLETS & ENERGY:
WOOD PELLETS AND
BLACK PELLETS

RCG is a flaking machine generating enough centrifugal strength to maintain the chips constantly pressed against the knives and fight the shearing stress.

TECHNICAL FEATURES

- Very high precision knife ring • High number of knives • Very high precision impeller provided with presetting system for counter-knives • Minimized gap among knives and counter-knives • High flaking speed and special setting to refine small-size material, i.e. micro-chips, oversize particles and sawdust cubes • Feeding door provided with air cleaner to reject heavy pollutants
- Machine parts getting in touch with chips are highly protected against wear
- Easy and quick replacement of knife-ring.

BENEFITS

- Excellent flakes from regular chips, fresh and recycled • Superior result from micro-chips, oversize particles and sawdust cubes • High efficiency • High reliability • Minimized maintenance costs • Low specific energy consumption.

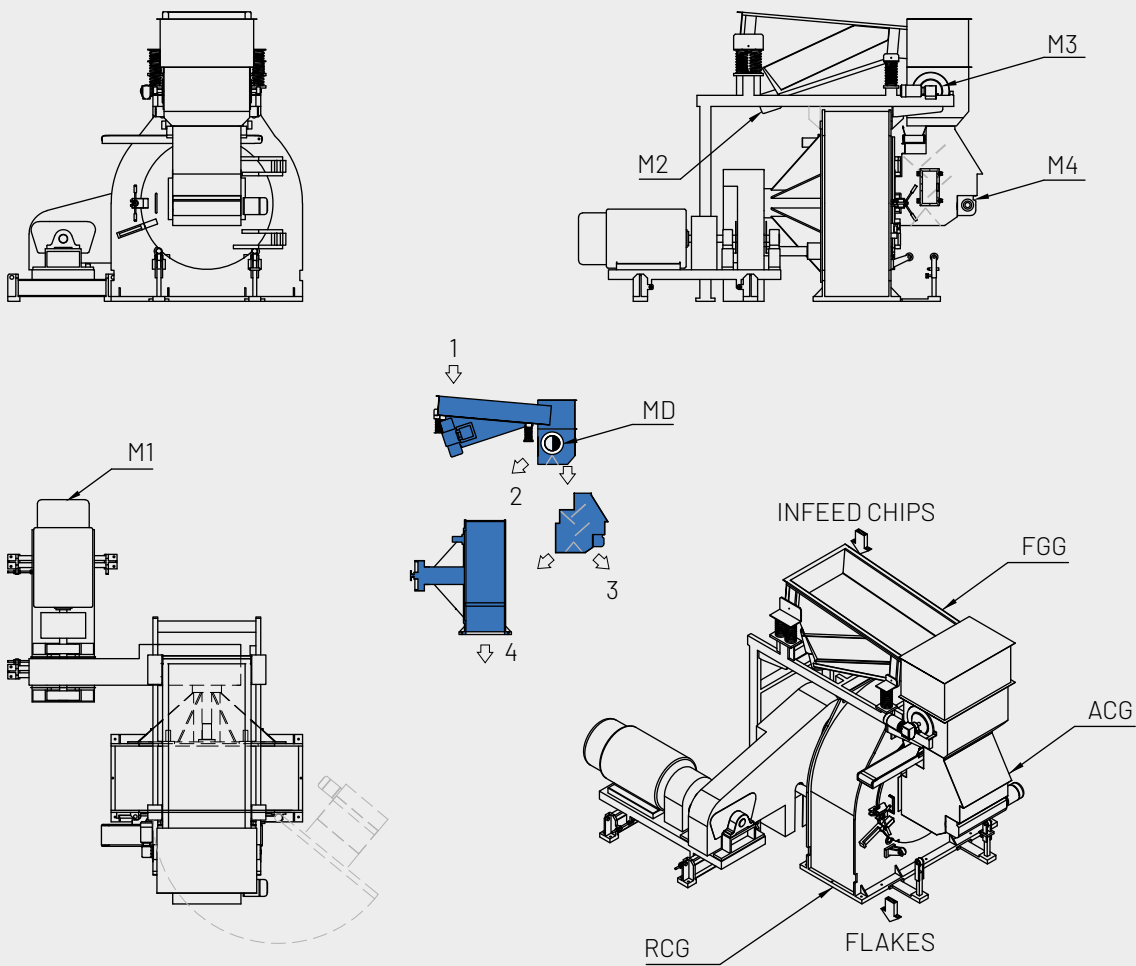

1 = INFEED CHIPS 3 = HEAVY POLLUTANTS M1 = MAIN MOTOR M3 = MAGNETIC DRUM (MD)
 2 = FERROUS POLLUTANTS 4 = FLAKES M2 = VIBRATING FEEDER M4 = WIND SELECTOR



MODEL	OVERALL DIMENSIONS mm	KNIFE RING DIAMETER mm	KNIVES No.	DIMENSIONS OF KNIVES mm	MAIN MOTOR kW	WEIGHT WITHOUT MAIN MOTOR kg
RCG 10.360	2050 x 1810 x 1300	1000	36	350 x 90 x 4	132 / 200	3800
RCG 12.450	2200 x 1980 x 1730	1200	46	450 x 80 x 4	132 / 200	5900

RCG 10.360

RCG 12.450

